

TILE INSTALLED OVER MASONRY OR CONCRETE WALLS - THIN-SET METHOD

INTERIOR/EXTERIOR

303W-2009/2010

SUITABLE SUBSTRATES

- Concrete or masonry.

MATERIALS

- TILE
 - Interior and dry areas:** All tile types as recommended by the manufacturer.
 - Exterior:** Frost resistant materials only.
- SLIGHT LEVELLING COAT, if required.
 - Interior:** **Flextile 57 Scratch Coat**
 - Exterior:** **Flextile 57 Scratch Coat / 43 Mortar Additive**
- WATERPROOF MEMBRANE (as required)
 - Flextile WP 900 or WP980 Waterproof & Crack Isolation Membrane (ANSI A118.10/A118.12)**
- BOND COAT
 - Interior:**
 - Flextile 51 Thin-set Mortar (ANSI A118.1)**
 - Flextile 51/44 two-component Latex Mortar System (ANSI A118.4/A118.11)**
 - Flextile 52, 56SR or 66 Polymer Modified Thin-Set Mortars (ANSI A118.4/A118.11)**
 - *Flextile Flex-Epoxy 100 Epoxy Mortar (ANSI A118.3) *Special application only**
 - Exterior:**
 - Flextile 51/44 two-component Latex Mortar System (ANSI A118.4/A118.11)**
 - Flextile 58XT Fast Set two-component Latex Mortar System (A118.4/A118.11)**
- GROUT
 - Interior:** **Flextile Polymer Modified Grout (ANSI A118.7)**
 - Flextile Flex-Epoxy 100 – 100% Solids Epoxy Grout (ANSI A118.3)**
 - ColourMax Plus Urethane Grout**
 - Exterior:** **Flextile Polymer Modified Grout (ANSI A118.7)**
 - ColourMax Plus Urethane Grout**

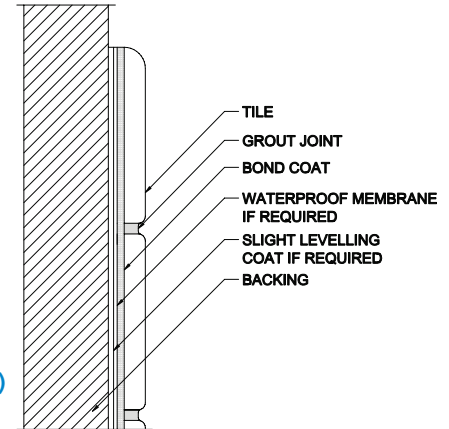

APPLICATION

- Surface variation not to exceed 6 mm in 3049 mm or 2 mm in 305 mm. Apply levelling coat if required. Apply thin-set bond coat according to manufacturer's instructions. Use proper notched trowel to ensure adequate bond. Slide tile firmly into position. Use sufficient bond coat to ensure minimum 95% contact on exterior surfaces and wet areas and minimum 80% on interior dry surfaces. Force grout into full depth of joint, remove excess grout and clean.

LIMITATIONS

- Manufacturer's recommendations to be followed. Exterior tile installations not to be attempted when temperature is less than 12°C. Do not use paper-back mounted tile. Mesh-back mounted tile for exterior use or in locations of extreme moisture should not be used unless the manufacturer guarantees that the material is suitable for this type of installation.

OTHER CONSIDERATIONS

- Tile used on exterior applications to be frost resistant.
- Refer to Notes For The Professional and 301MJ-2009/2010.
- Waterproof membrane if required must be specified. (ANSI A118.10-1999). Follow manufacturer's recommendations.
- Latex Portland cement mortars may require 14 – 60 days cure before exposure to water. Verify with the manufacturer the correct cure time required. Alternatively, to reduce the curing time required, a rapid set mortar may be more suitable.

2 mm = 1/16"
 6 mm = 1/4"
 7 mm = 5/16"
 20 mm = 3/4"
 305 mm = 12"
 3049 mm = 10'

12°C = 54° F
 20°C = 68° F



The above installation detail is used with the permission of the Terrazzo Tile & Marble Association of Canada. The installation products shown are Flextile's product recommendations for this specific detail, and are not intended to replace TTMAC's original generic specification.