

TILE INSTALLED ON INTERIOR/EXTERIOR CEILINGS OR SOFFITS

DETAIL A – MORTAR BED OVER CONCRETE

315C-2009/2010

SUITABLE SUBSTRATES

- Clean, sound, stable concrete.

MATERIALS

- TILE
- METAL LATH (optional) 1.4 kg/m² (ASTM C847-95)
- SCRATCH COAT (7 mm minimum)
Flexile 57 Scratch Coat (mixed with 43 Mortar Additive for Exterior Use)
- MORTAR BED. (20 mm+)
Flexile Dry Pack Mortar with Flexile 57 Slurry Bond Coat
- BOND COAT
Interior: Flexile 52, 56SR or 66 Polymer Modified Mortars (ANSI A118.4/A118.11)
Flexile 51 or 53 / 43 or 44 – two component Latex Portland Cement Mortar System (ANSI A118.4/A118.11)
Flexile 58XT Fast Set two-component Latex Mortar System (ANSI A118.4/A118.11)
Exterior: Flexile 51/ 44 two-component Latex Mortar System (ANSI A118.4/A118.11)
Flexile 58XT Fast Set two-component Latex Mortar System (ANSI A118.4/A118.11)
- GROUT
Interior: Flexile Polymer Modified Grout (ANSI A118.7)
ColourMaxPlus Urethane Grout
Exterior: Flexile 600 Polymer Modified Sanded Grout (ANSI A118.7)
ColourMaxPlus Urethane Grout

APPLICATION

- Attach metal lath, if required, according to manufacturer's recommendations. Apply scratch coat and cure overnight. Apply mortar bed to required thickness. Finished tolerance of mortar bed not to exceed 6 mm in 3049 mm or 2 mm in 305 mm. Apply tile to bond coat, before bond coat skins over. Use sufficient bond coat to ensure minimum 95% contact on exterior surfaces and wet areas and a minimum 80% on interior surfaces. Contact to be evenly distributed to give full support of the tile. Slide tile firmly into position. Beat mosaic tile into position. Allow bond coat to cure. Force grout into full depth of joint, remove excess grout and clean.

LIMITATIONS

- Manufacturer's recommendations must be followed.
- Do not use paper-back or mesh-back mounted tile for exterior use or in locations of extreme moisture unless the manufacturer guarantees that the material is suitable for this type of installation.
- For thin-set method concrete surface must be clean, dimensionally stable, cured and free of contaminants such as oil, sealers, paint and curing compounds.

OTHER CONSIDERATIONS

- Latex additive is recommended for modification of scratch coat, mortar bed and Portland cement bond coat. Follow manufacturer's recommendations. Where job conditions require additional thickness, allow 24 hours cure between coats.
- Tile used on exterior applications must be frost resistant.
- Refer to Notes For The Professional and 301MJ- 2009/2010.
- Waterproof membrane if required must be specified. (ANSI A118.10-1999)
- Follow manufacturer's recommendations
- Latex-Portland cement mortars may require 14 – 60 days cure before exposure to water. Verify with the manufacturer the correct cure time required. Alternatively, to reduce the curing time required, a rapid set mortar may be more suitable.
- For ease of installation a non sag mortar or light weight mortar may be considered.
- For thin-set applications see Detail A-2.

A

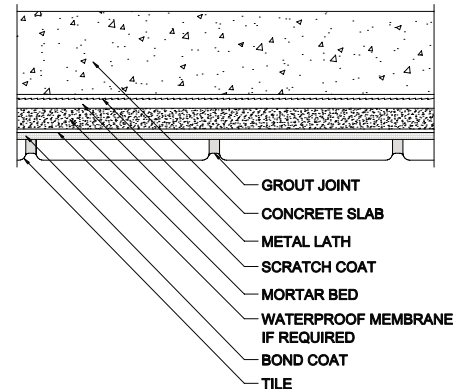

The above installation detail is used with the permission of the Terrazzo Tile & Marble Association of Canada. The installation products shown are Flexile's product recommendations for this specific detail, and are not intended to replace TTMAC's original generic specification.

DETAIL B – THIN-SET METHOD OVER 315C-2009/2010 BACKER UNIT/BOARD

SUITABLE SUBSTRATES

- Wood or metal studs, maximum 406 mm o.c.

MATERIALS

- VAPOUR RETARDER – 6 mils polyethylene film – Required in exterior and wet areas.
- Cementitious backer units (CBU) (ANSI A118.9-1999) or coated glass mat backer board (ASTM C1178-1996) or gypsum board (ASTM C36-1997) (dry areas only)
- TILE
- TAPE – 51 mm fibre mesh
- SLIGHT LEVELLING COAT: if required.
- WATERPROOF MEMBRANE (as required)
Flextile WP900 or WP980 Waterproof & Crack Isolation Membrane (ANSI A118.10/A118.12)
- BOND COAT
**Interior: Flextile 52, 56SR or 66 Polymer Modified Mortars (ANSI A118.4/A118.11)
Flextile 51 or 53 / 43 or 44 – two component Latex Portland Cement Mortar System (ANSI A118.4/A118.11)
Flextile 58XT Fast Set two-component Latex Mortar System (ANSI A118.4/A118.11)**
**Exterior: Flextile 51 or 53 / 44 – two component Latex Portland Cement Mortar System (ANSI A118.4/A118.11)
Flextile 58XT Fast Set two-component Latex Mortar System (ANSI A118.4/A118.11)**
- GROUT
**Interior: Flextile Polymer Modified Grout (ANSI A118.7)
ColourMaxPlus Urethane Grout**

APPLICATION

- Cementitious backer unit (CBU) or coated glass mat backer board must be level, stable, square and screwed to studs with corrosion resistant screws. Do not countersink screws. Surface variation in the backing not to exceed 6 mm in 3049 mm or 2 mm in 305 mm. Apply levelling coat if required. All joints must be taped with 51 mm fibre mesh tape, filled with a dry-set or latex mortar, and sanded. Do not sand coated glass mat backer board unless a waterproof membrane is used after sanding. Apply thin-set bond coat to cement board surface using proper notched trowel to ensure adequate bond. Slide tile or beat mosaic firmly into position while bond coat is wet and tacky. Use sufficient bond coat to ensure minimum 95% contact on exterior surfaces and wet areas and minimum 80% on interior surfaces. Force grout into full depth of joint, remove excess grout and clean.

LIMITATIONS

- Manufacturer's recommendations must be followed. Exterior tile installations should not be attempted when temperature is less than 12°C. Do not use paper-back or mesh-back mounted tile for exterior use or in locations of extreme moisture unless the manufacturer guarantees that the material is suitable for this type of installation.
- Framing for ceiling shall be capable of supporting weight of tile and backup system.
- A waterproof membrane or vapour retarder not to be used behind coated glass mat backer board.
- All requirements for exterior applications must be met
- Coated glass mat backer board is not recommended for exterior applications.

OTHER CONSIDERATIONS

- Spacing and minimum gauge of steel studs as per instructions of manufacturer of cementitious backer unit (CBU) or coated glass mat backer board on exterior installation.
- Waterproof membrane if required must be specified. (ANSI A118.10-1999).
- Tile used on exterior applications must be frost resistant.
- Refer to Notes For The Professional and 301MJ- 2009/2010.
- For high use showers (hotels, gang showers, sports facilities, etc.) a waterproof membrane shall be used.
- All openings and cuts must be treated to ensure waterproof integrity.
- Latex-Portland cement mortars may require 14 – 60 days cure before exposure to water. Verify with the manufacturer the correct cure time required. Alternatively, to reduce the curing time required, a rapid set mortar may be more suitable.

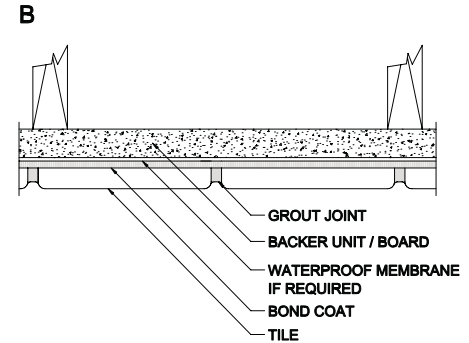

The above installation detail is used with the permission of the Terrazzo Tile & Marble Association of Canada. The installation products shown are Flextile's product recommendations for this specific detail, and are not intended to replace TTMAC's original generic specification.