

TILE INSTALLED OVER GYPSUM BOARD - THIN-SET METHOD

304W-2009/2010

DRY AREAS ONLY

SUITABLE SUBSTRATES

- Gypsum board
- Wood or metal strapping, or studs. Maximum 406 mm o.c.

MATERIALS

- TILE
- TAPE – 51 mm drywall tape
- SLIGHT LEVELLING COAT, if required.
Flextile 57 Scratch Coat
- BOND COAT
Flextile 200, 210 or 90 Type 1 Adhesives (ANSI A136.1)
Flextile 51 Thin-set Mortars (ANSI A118.1)
Flextile 52, 56SR or 66 Polymer Modified Thin-Set Mortars (ANSI A118.4/A118.11)
- GROUT
Flextile Polymer Modified Grout (ANSI A118.7)
Flextile Flex-Epoxy 100 – Epoxy Grout (ANSI A118.3)
ColourMax Plus Urethane Grout

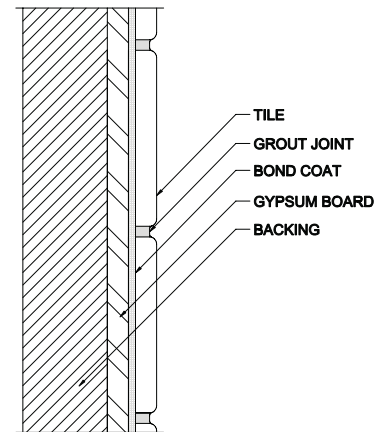

APPLICATION

- Gypsum board (13 mm minimum) to be stable, plumb, square and screwed to studs. All joints to be taped and sanded. Apply bond coat and install tile while bond coat is wet and tacky. Slide tile into position. Use sufficient bond coat to ensure minimum 80% contact. Force grout into full depth of joint. Remove excess grout and clean.

LIMITATIONS

- Organic adhesives are not recommended for use in areas exposed to temperatures above 60°C. Type of organic adhesives to be recommended by the manufacturer.
- Organic adhesives – Manufacturer's recommendations must be followed for use and suitability with non-absorbent tile.

OTHER CONSIDERATIONS

- Heavy lug tiles are not recommended, but if used, to be set only with latex cement mortars.
- Special care to be taken when installing tile thicker than 13 mm to prevent slippage or debonding. Refer to Notes For The Professional and 301MJ-2009/2010.
- This system not to be used in wet or exterior areas such as showers, bath surrounds, steam rooms or exterior installations.



The above installation detail is used with the permission of the Terrazzo Tile & Marble Association of Canada. The installation products shown are Flextile's product recommendations for this specific detail, and are not intended to replace TTMAC's original generic specification.