

TILE INSTALLED OVER CEMENTITIOUS BACKER UNIT (CBU)

DETAIL A - ON BATH TUB/WALLS - THIN-SET METHOD

306W-2009/2010

SUITABLE SUBSTRATES

- Wood or metal studs, maximum 406 mm o.c.

MATERIALS

- VAPOUR RETARDER - 6 mils polyethylene film.
- CEMENTITIOUS BACKER UNIT (CBU) - Minimum 13 mm thick. (ANSI A118.9-1999) or nominal 11 mm thick fibre-cement backer board meeting ASTM C1288-1999.
- TILE
- TAPE - 51 mm fibre mesh
- WATERPROOF MEMBRANE (if required, with Latex Mortar Bond Coat only)
Flextile WP900 or WP980 Waterproof & Crack Isolation Membrane (ANSI A118.10/A118.12)
- BOND COAT - Latex-Portland cement mortar or Type I organic adhesive when recommended by manufacturer. ANSI A136.1-1999.
Flextile 200, 210 or 90 Type 1 Adhesives (ANSI A136.1)
Flextile 51 / 44 Latex Mortar System (ANSI A118.4/A118.11)
Flextile 52, 56SR or 66 Polymer Modified Thin-Set Mortars (A118.4/A118.11)
- GROUT – Latex Portland cement, epoxy or dry-set.
Flextile Polymer Modified Grout (ANSI A118.7)
Flextile Flex-Epoxy 100 – 100% Solids Epoxy Grout (ANSI A118.3)
ColourMax Plus Urethane Grout
- SEALANT – Silicone rubber or prefabricated movement joint (PMJ)

APPLICATION

- Surface variation in the backing not to exceed 6 mm in 3049 mm or 2 mm in 305 mm. Attach cementitious backer unit (CBU) to studs with corrosion resistant fasteners 152 mm o.c. Leave 3 mm space around perimeter of each board. Leave 6 mm space between bottom of tile and bath to allow for stud shrinkage and bath deflection during filling or emptying. All joints to be taped with 51 mm fibre-mesh tape. Fill with dry-set or latex mortar and sand. Apply bond coat to cement board using proper notched trowel. Use sufficient bond coat to ensure a minimum of 95% contact in wet areas and minimum of 80% contact in dry areas. Slide tile firmly into position before bond coat skins over. Allow bond coat to cure before grouting. Force grout into full depth of joint, remove excess grout and clean.

LIMITATIONS

- Manufacturer's recommendations to be followed. Exterior tile installations not to be attempted with a temperature of less than 12°C. Do not use paper-back mounted tile. Mesh-back mounted tile for exterior use or in locations of extreme moisture should not be used unless the manufacturer guarantees that the material is suitable for this type of installation.
- Manufacturer's recommendations must be followed.
- Do not use paper-back or mesh-back mounted tile for exterior use or in locations of extreme moisture unless the manufacturer guarantees that the material is suitable for this type of installation.

OTHER CONSIDERATIONS

- This detail may be used with water-resistant gypsum board provided that a suitable waterproof membrane is installed over gypsum board prior to application. (ANSI A118.10-1999)
- Prefabricated movement joints (PMJ) may be used in place of sealant, where showing on drawings or where two planes meet.
- Refer to Notes For The Professional and 301MJ-2009/2010.
- For high use showers (hotels, gang showers, sports facilities etc.) a waterproof membrane shall be used.
- All openings and cuts must be treated to ensure waterproof integrity.
- Waterproof membrane if required must be specified. (ANSI A118.10-1999) Follow manufacturer's recommendations.
- For defective substrates fill tub with water prior to applying caulking to tub sill.

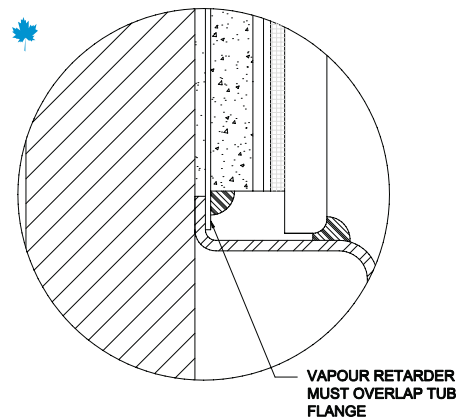
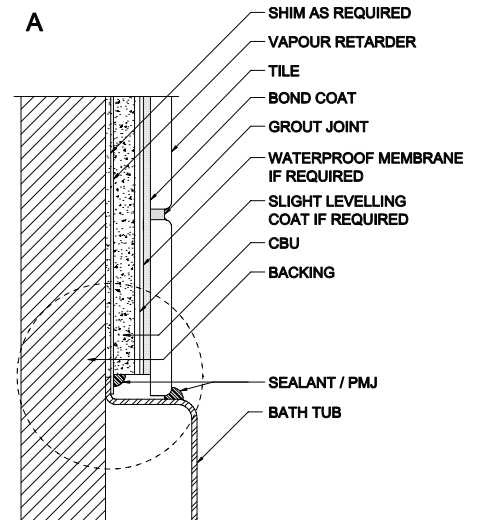

The above installation detail is used with the permission of the Terrazzo Tile & Marble Association of Canada. The installation products shown are Flextile's product recommendations for this specific detail, and are not intended to replace TTMAC's original generic specification.

TILE INSTALLED OVER COATED GLASS MAT BACKER BOARD

DETAIL B- ON BATH TUB/WALLS – THIN-SET METHOD

306W-2009/2010

INTERIOR ONLY

SUITABLE SUBSTRATES

- Wood or metal studs, maximum 406 mm o.c.

MATERIALS

- Coated glass mat backer board – minimum 13 mm thick. (ASTM C1178-96)
- TILE
- E - 51 mm wide fibre mesh tape
- BOND COAT - Latex-Portland cement mortar or Type I organic adhesive when recommended by manufacturer. ANSI A136.1-1999.
[Flextile 200, 210 or 90 Type 1 Adhesives \(ANSI A136.1\)](#)
[Flextile 51 / 44 Latex Mortar System \(ANSI A118.4/A118.11\)](#)
[Flextile 52, 56SR or 66 Polymer Modified Thin-Set Mortars \(A118.4/A118.11\)](#)
- GROUT – Latex Portland cement, epoxy or dry-set.
[Flextile Polymer Modified Grout \(ANSI A118.7\)](#)
[Flextile Flex-Epoxy 100 – 100% Solids Epoxy Grout \(ANSI A118.3\)](#)
[ColourMax Plus Urethane Grout](#)
- SEALANT – Silicone rubber or prefabricated movement joint (PMJ)

APPLICATION

- Attach coated glass mat backer board to studs with rust resistant screws or nails. Fasteners shall be spaced 152 mm o.c. with coated grey side away from the studs. Leave 6 mm space between bottom of tile and bath to allow for stud shrinkage and bath deflection during filling and emptying. Drive fasteners flush with coated surface. Do not countersink. Surface variation in the backing not to exceed 6 mm in 3049 mm or 2 mm in 305 mm and can be applied either parallel or perpendicular to framing. Apply levelling coat if required. Tape joints with 51 mm fibre-mesh tape, fill with a dry-set or latex mortar. Do not sand coated glass mat backer board unless a waterproof membrane is used after sanding. Apply thin-set bond coat to coated glass mat backer board using proper notched trowel to ensure adequate bond. Use sufficient bond coat to ensure a minimum 95% contact in wet areas. Slide tile firmly into position while bond coat is wet and tacky. Force grout into full depth of tile joint. Remove excess grout and clean.

LIMITATIONS

- Follow manufacturer's recommendations. Coated glass mat backer board should not be used where prolonged exposure to heat exceeds 52°C. It is not recommended for use with passive solar heat systems. Maximum tile size is 356 mm x 356 mm x 10 mm. Do not apply directly over concrete or masonry block. Do not use paper-back or mesh-back mounted tile in locations of extreme moisture unless the manufacturer guarantees that the material is suitable for this type of installation. A waterproof membrane or vapour retarder not be used behind coated glass mat backer board.

OTHER CONSIDERATIONS

- Movement joints, spacing and minimum gauge of steel studs as per instructions of manufacturer of coated glass mat backer board.
- Prefabricated movement joints (PMJ) may be used in place of sealant, where shown on drawings where two planes meet.
- All openings and cuts must be treated to ensure waterproof integrity.
- Refer to Notes For The Professional and 301MJ-2009/2010.
- Latex Portland cement mortars may require 14 – 60 days cure before exposure to water. Verify with the manufacturer the correct cure time required. Alternatively, to reduce the curing time required, a rapid set mortar may be more suitable.
- For defective substrates fill tub with water prior to applying caulking to tub sill.

B

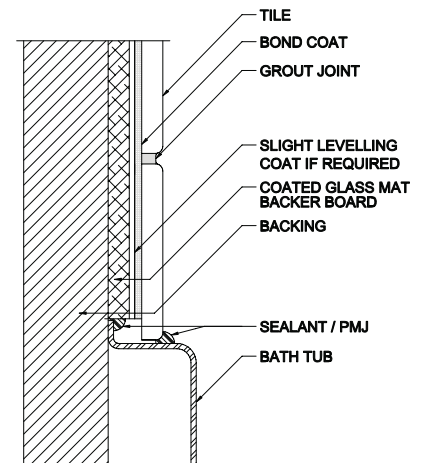

The above installation detail is used with the permission of the Terrazzo Tile & Marble Association of Canada. The installation products shown are Flextile's product recommendations for this specific detail, and are not intended to replace TTMAC's original generic specification.